

Concept along East Arapahoe in Boulder w/ Station

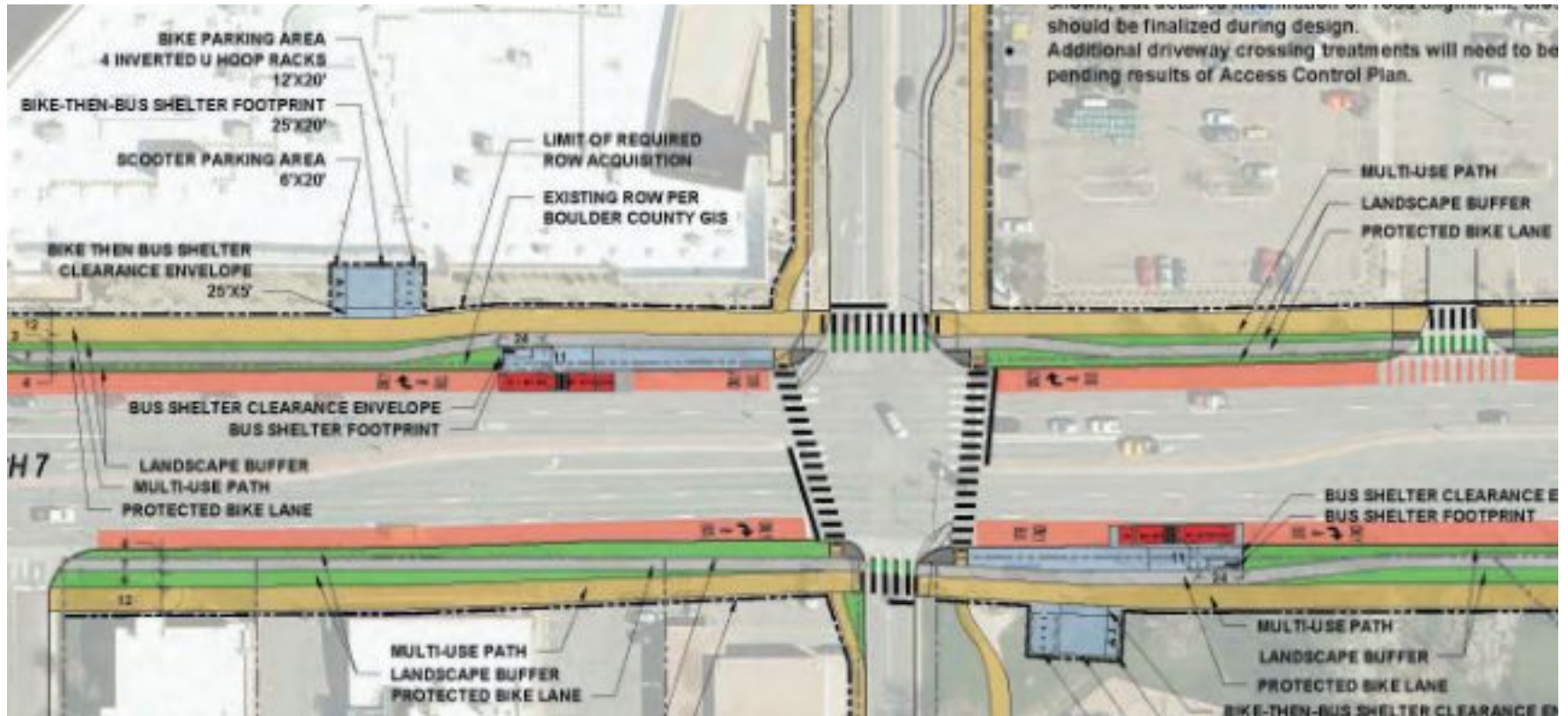

East Arapahoe Plan - 28th to 64th typical

Recommended Alternative (typical)

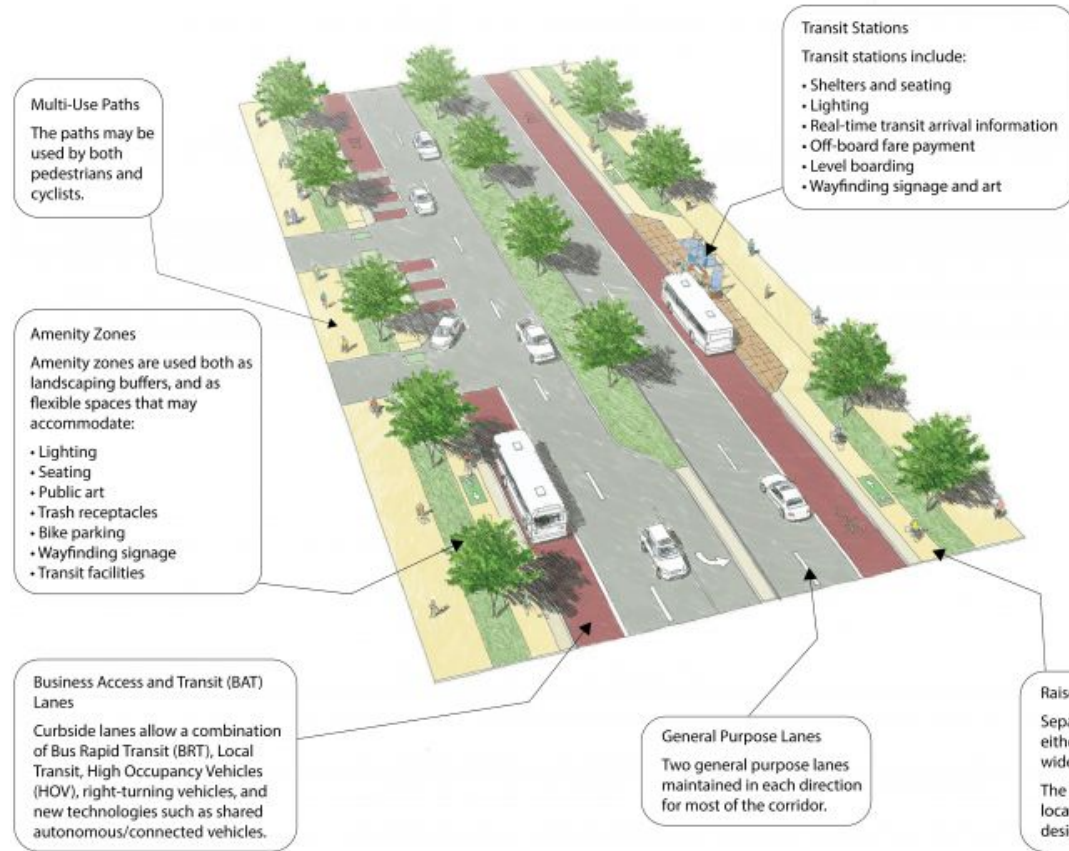

Pedestrian and Bicycle Facility Options

Two design options for pedestrian and bicycle facilities are feasible and will likely vary by location. The configuration will be refined in a later design phase.

Design Option 1



A narrow paved buffer separates the protected bike lane from the roadway, and a wide amenity zone with street trees is located between the protected bike lane and the multi-use path.

Design Option 2



A wide amenity zone with street trees separates the protected bike lane from the roadway, and a narrower amenity zone is located between the protected bike lane and the multi-use path.

Raised Protected Bike Lanes

Separated from the roadway by either a narrow paved buffer, or a wide amenity zone with street trees. The configuration will likely vary by location and be refined in a later design phase.

Street Sections

US 287 to 119th Street



Street Sections

Relocated County Line Road to Sheridan Parkway



Street Sections

Sheridan Parkway to York Street



Street Sections

Sheridan Parkway to York Street



Street Sections

Holly Street to US 85

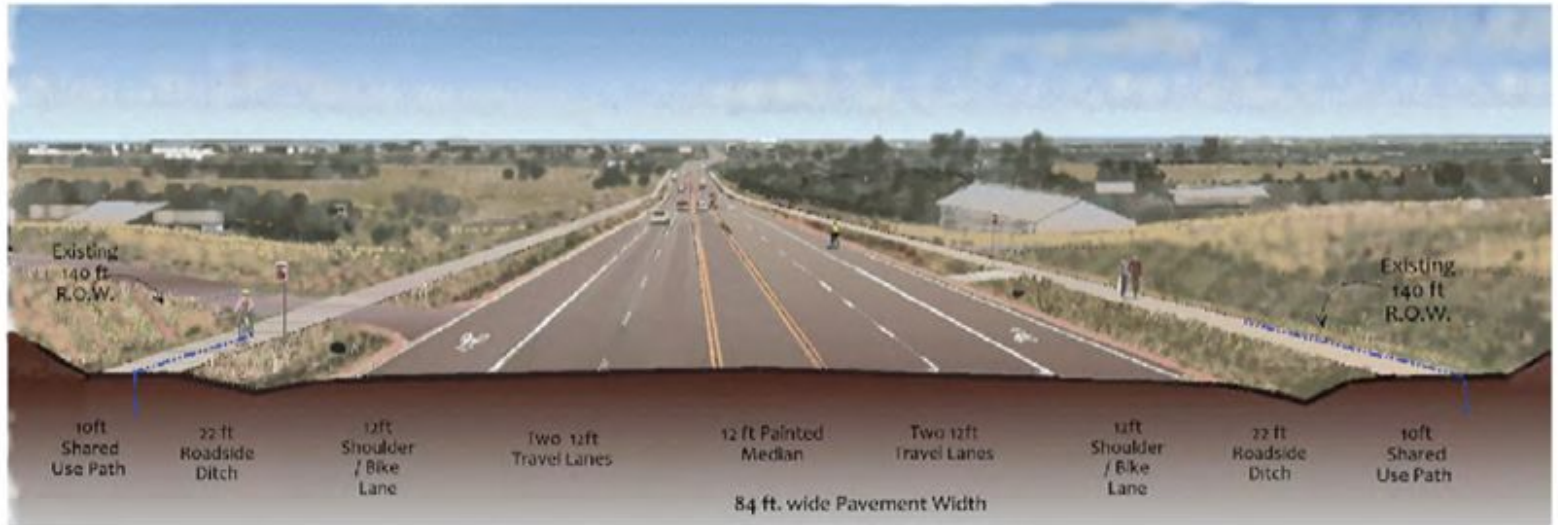

CO 7 Intersection Station Concept w/ Queue Jump Lanes

Quebec St. & SH7

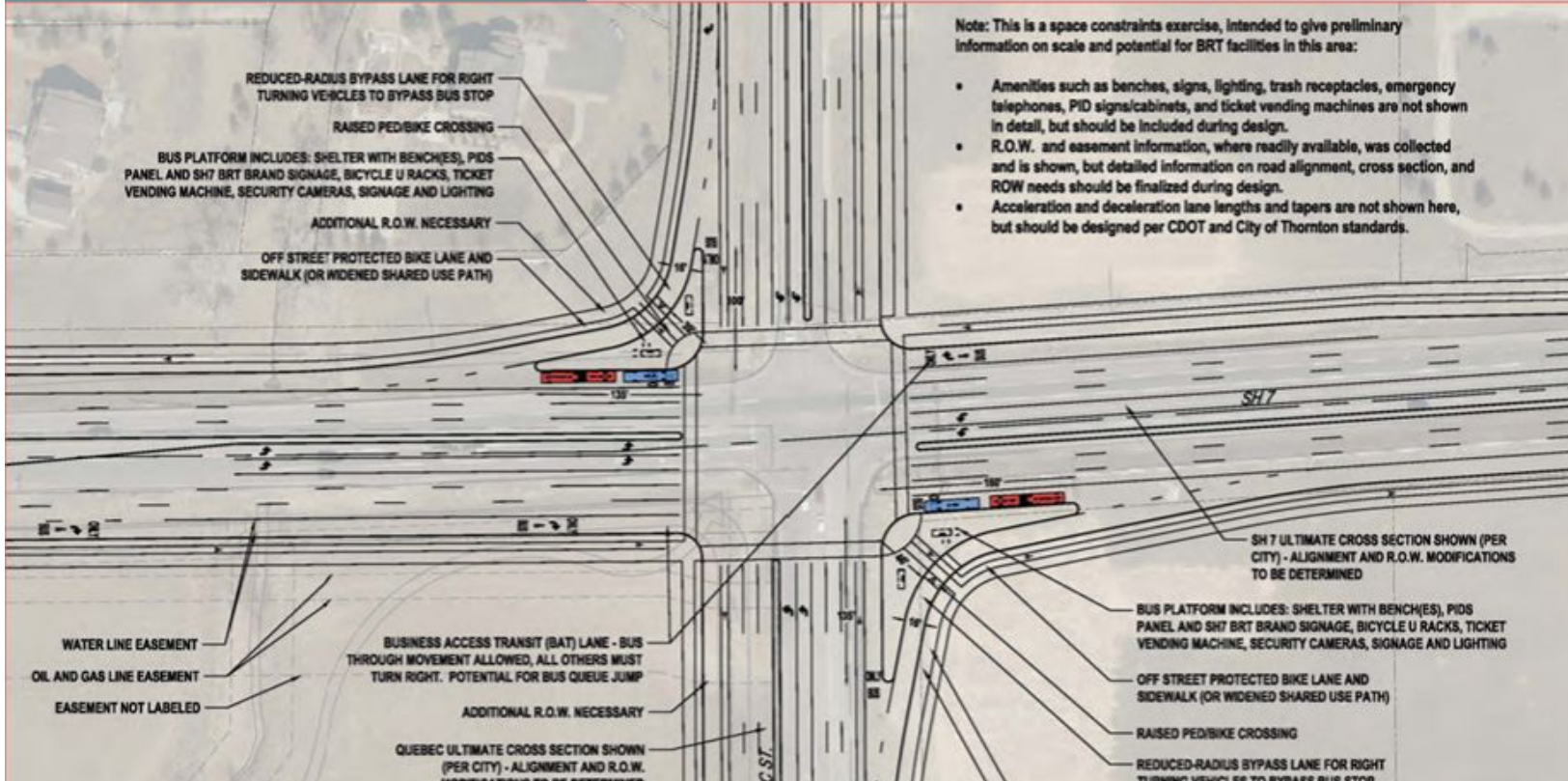

Note: This is a space constraints exercise, intended to give preliminary information on scale and potential for BRT facilities in this area:

- Amenities such as benches, signs, lighting, trash receptacles, emergency telephones, PID signs/cabinets, and ticket vending machines are not shown in detail, but should be included during design.
- R.O.W. and easement information, where readily available, was collected and is shown, but detailed information on road alignment, cross section, and ROW needs should be finalized during design.
- Acceleration and deceleration lane lengths and tapers are not shown here, but should be designed per CDOT and City of Thornton standards.